



For FA/Machine Vision
Fixed Focal

HF12.5HA-1B

Applicable camera (model)

1 2/3 1/2 1/3 1/4

FIXED
Fixed Focal

1.5 Mega
For Megapixel Camera

MANUAL
Manual Iris

C-mt
C Mount

METAL
Metal Mount

F1.4
Wide Aperture Rate



- High-resolution design, providing support for up to 1.5 megapixel camera resolution.
- Low-distortion design achieving accurate image input.
- Compact, lightweight and robust design, supporting various systems.
- Focus & iris lock tab provided, supporting environments such as vibration.

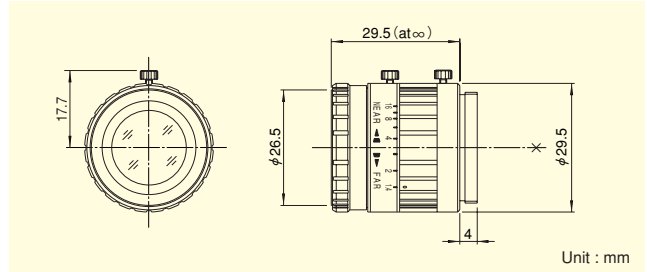

FIXED FOCAL LENGTH LENSES

Focal Length (mm)		12.5	Remarks • With Metal Mount • With Locking Knob for Iris and Focus
Iris Range		F1.4 ~ F16	
Operation	Focus	Manual	
	Iris	Manual	
Angle Of View (H×V)	2/3"	38°47' × 29°35'	
	1/2"	28°43' × 21°44'	
	1/3"	21°44' × 16°23'	
Focusing Range (From Front Of The Lens) (m)		∞ ~ 0.1	
Object Dimensions at M.O.D. (H×V) (mm)	2/3"	78 × 58	
	1/2"	57 × 42	
	1/3"	42 × 32	
Back Focal Distance (in air) (mm)		15.09	
Exit Pupil Position (From Image Plane) (mm)		-31	
Filter Thread (mm)		M25.5 × 0.5	
Mount		C	
Mass (g)		45	



For FA/Machine Vision
Fixed Focal

HF16HA-1B

Applicable camera (model)

1 2/3 1/2 1/3 1/4

FIXED
Fixed Focal

1.5 Mega
For Megapixel Camera

MANUAL
Manual Iris

C-mt
C Mount

METAL
Metal Mount

F1.4
Wide Aperture Rate



- High-resolution design, providing support for up to 1.5 megapixel camera resolution.
- Low-distortion design achieving accurate image input.
- Compact, lightweight and robust design, supporting various systems.
- Focus & iris lock tab provided, supporting environments such as vibration.

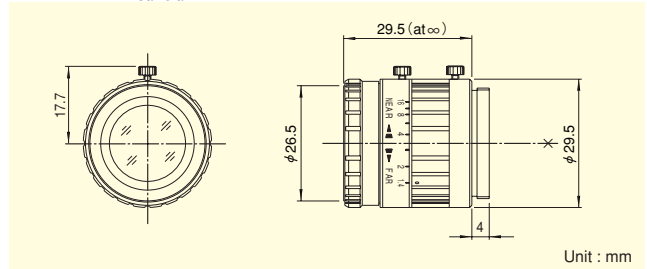

Focal Length (mm)		16	Remarks • With Metal Mount • With Locking Knob for Iris and Focus
Iris Range		F1.4 ~ F16	
Operation	Focus	Manual	
	Iris	Manual	
Angle Of View (H×V)	2/3"	30°45' × 23°18'	
	1/2"	22°37' × 17°04'	
	1/3"	17°04' × 12°50'	
Focusing Range (From Front Of The Lens) (m)		∞ ~ 0.1	
Object Dimensions at M.O.D. (H×V) (mm)	2/3"	63 × 47	
	1/2"	46 × 34	
	1/3"	34 × 26	
Back Focal Distance (in air) (mm)		15.15	
Exit Pupil Position (From Image Plane) (mm)		-31	
Filter Thread (mm)		M25.5 × 0.5	
Mount		C	
Mass (g)		45	

